

eduard
MASK

CX 013

B-24D Liberator

The die-cut mask for accurate canopy frame painting of the
Academy 1/72 KIT

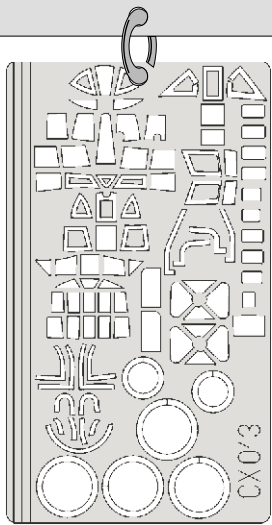

2pcs
53

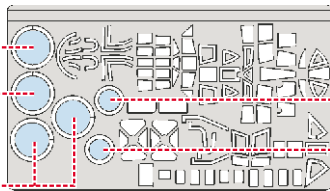
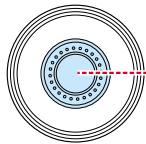

17

2pcs
52

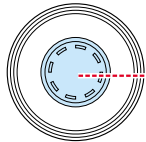

18

?

?

2pcs
53

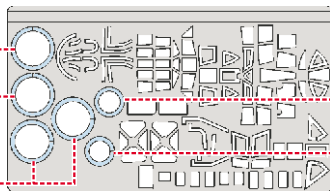
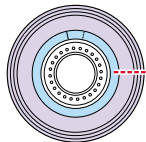

17

2pcs
52

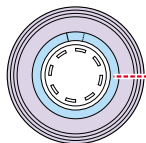

18

LIQUID MASK



1.)

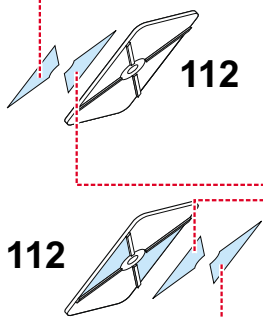

2.)

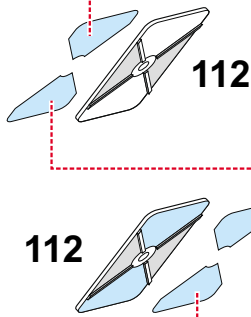

1.)

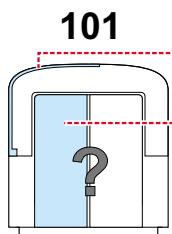

2.)

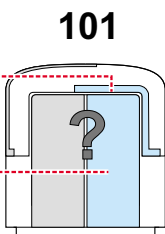

3.)

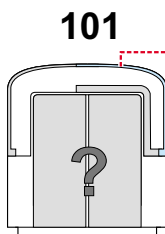

4.)

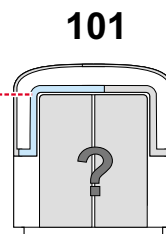

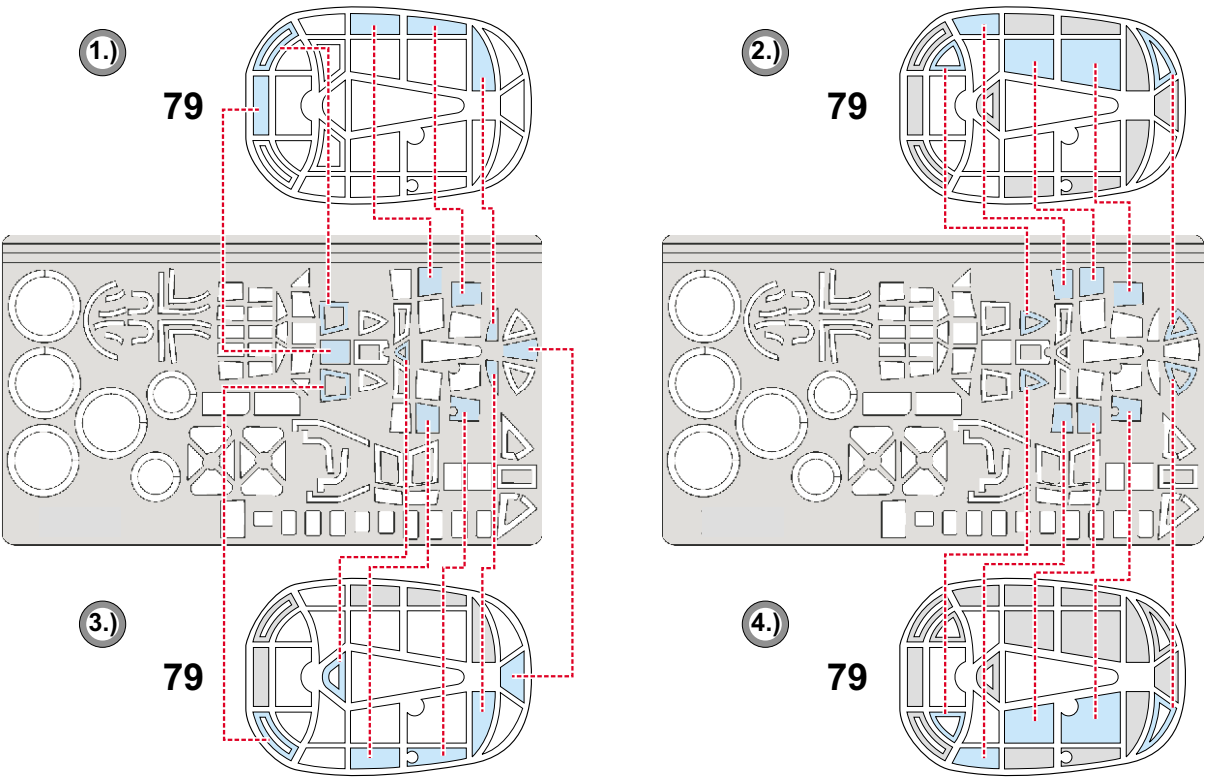
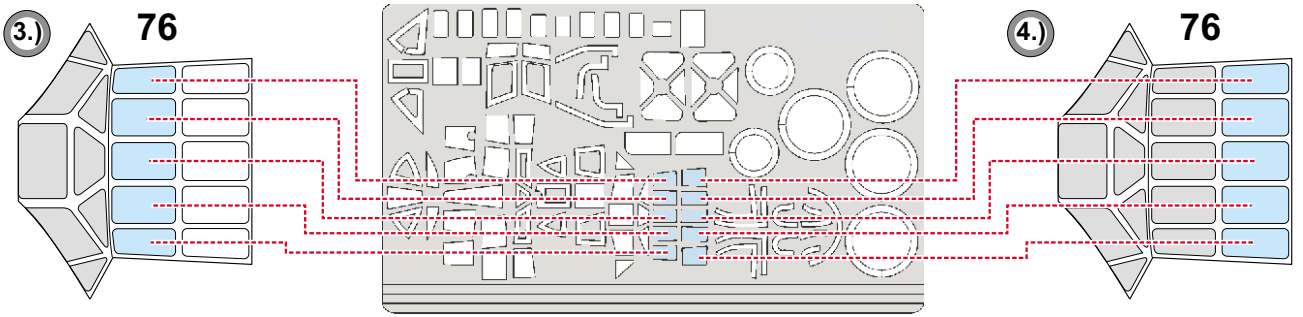
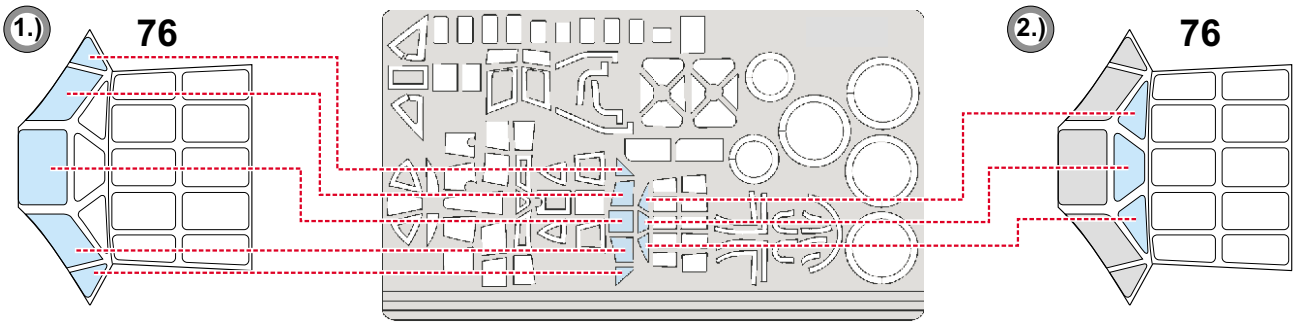
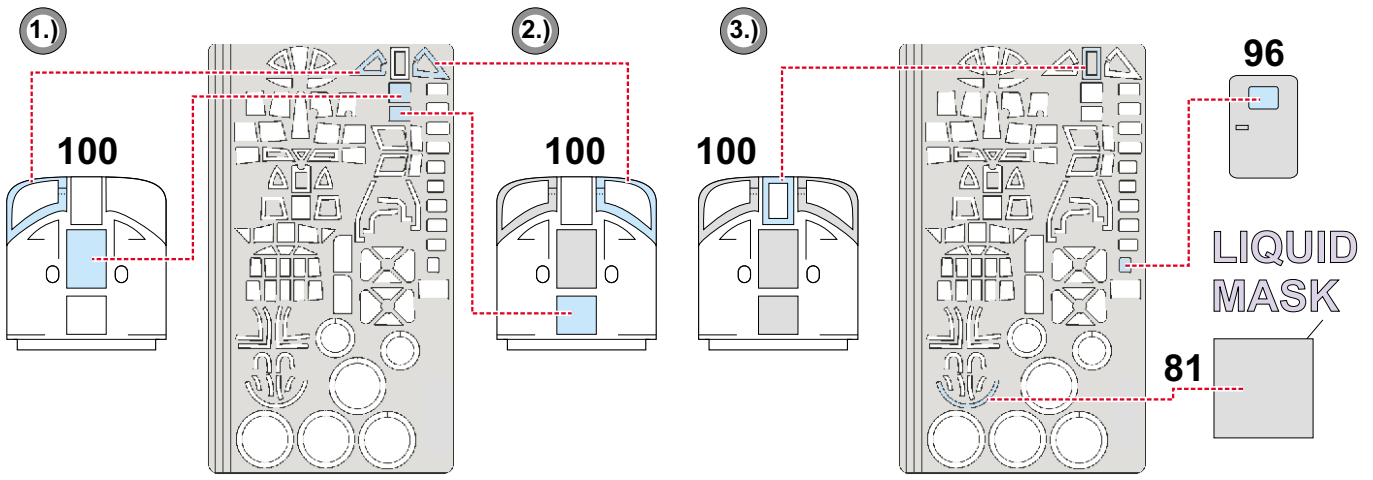

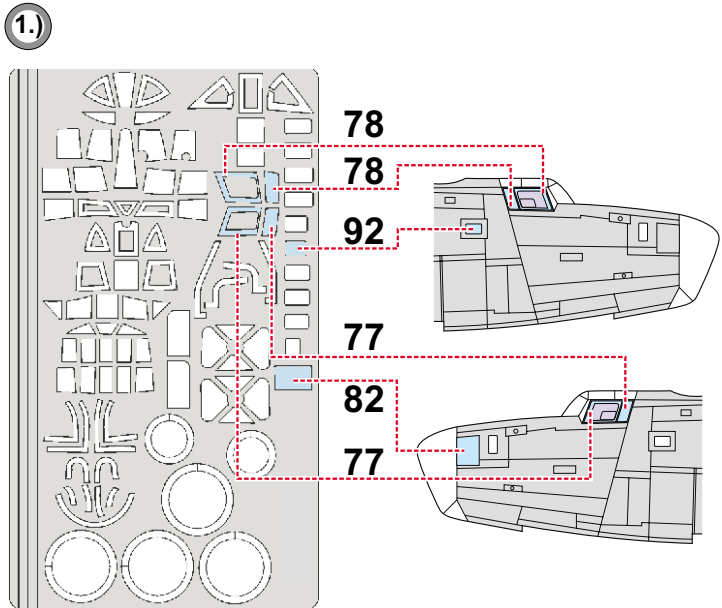
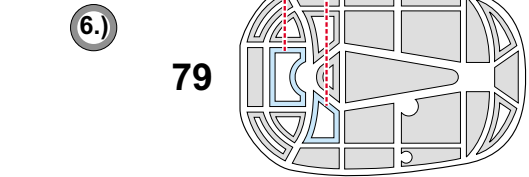
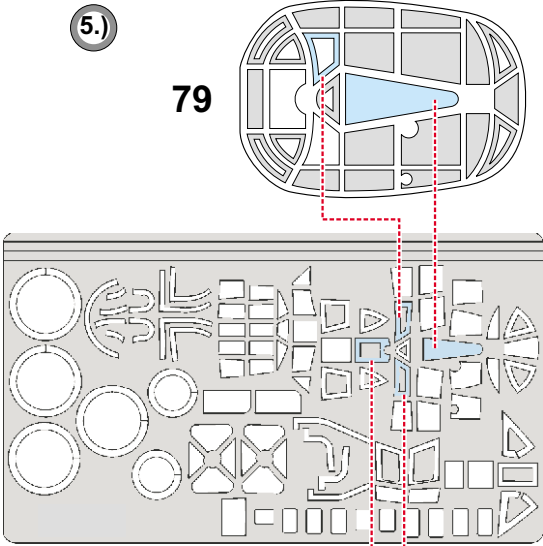

LIQUID MASK 

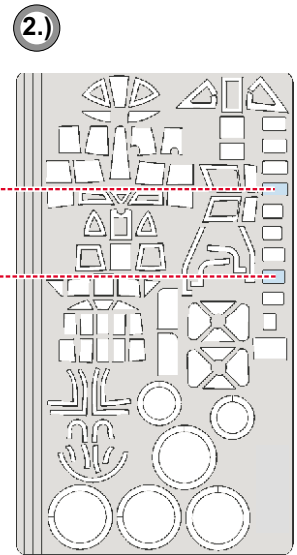
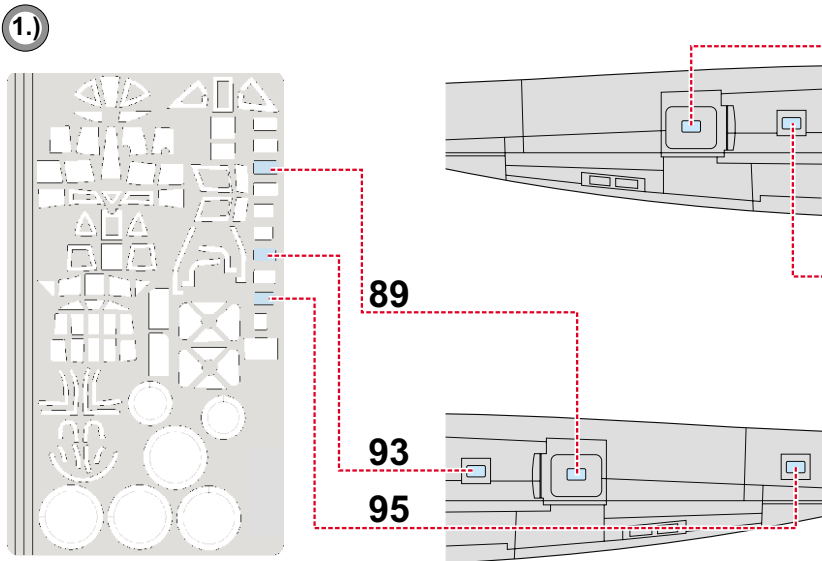
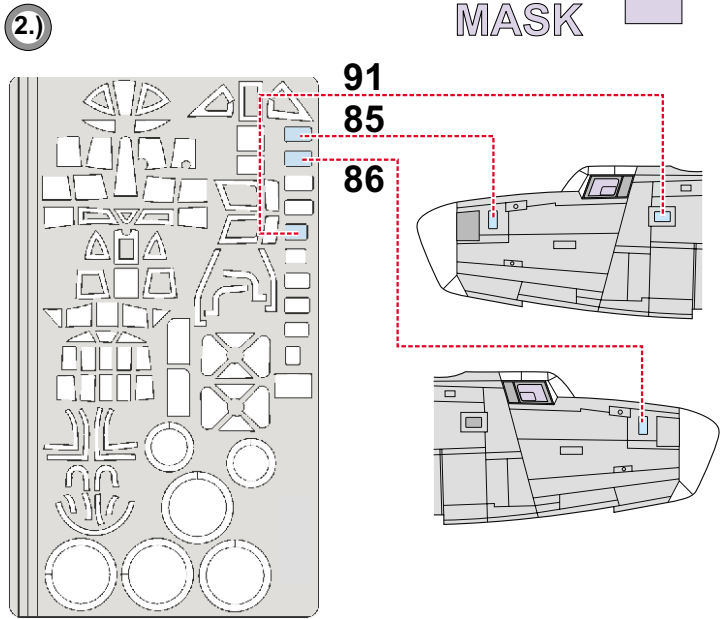

1.) 79

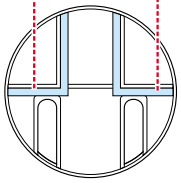
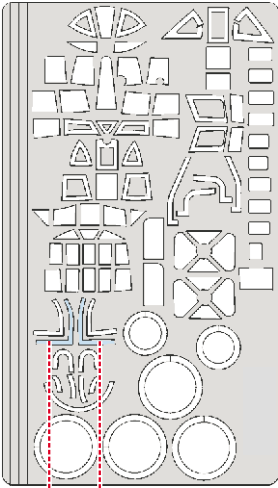

2.) 79

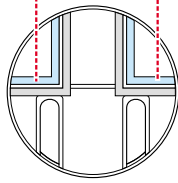
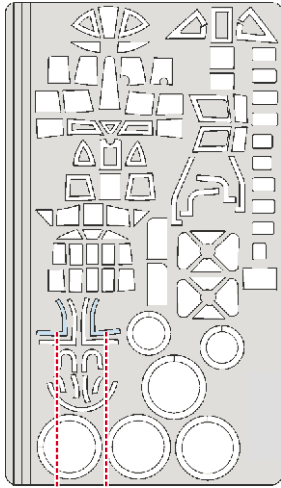

3.) INTERIOR COLOR

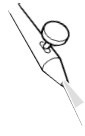

79

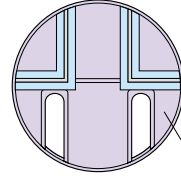

LIQUID MASK

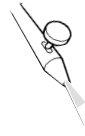

4.) CAMOUFLAGE COLOR

79

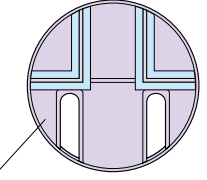

5.)

REMOVE MASK

79

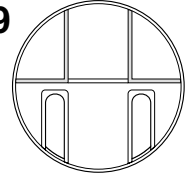

6.) 79

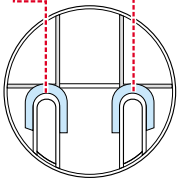
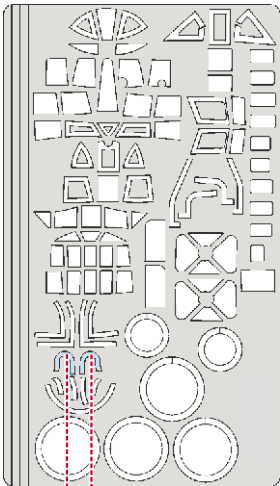

7.) 79

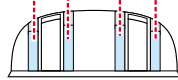
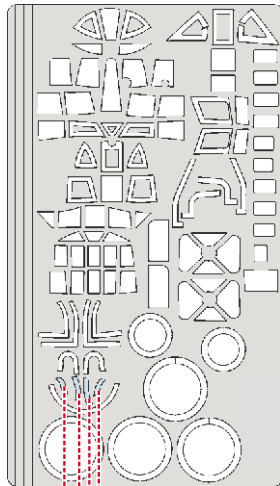

8.) INTERIOR COLOR



79

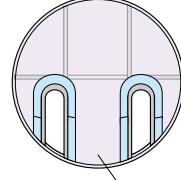

LIQUID MASK



9.) CAMOUFLAGE COLOR

79

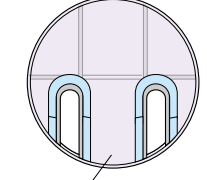

10.)

REMOVE MASK

79

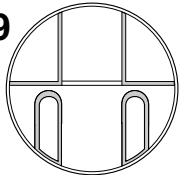

1.)



INTERIOR COLOR

2.)

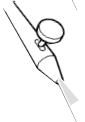

CAMOUFLAGE COLOR

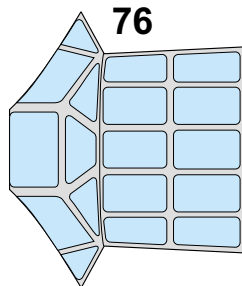

76

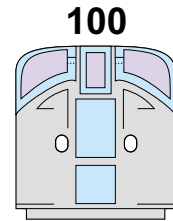

100

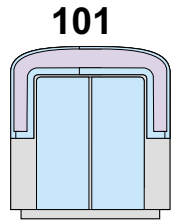

101

LIQUID MASK

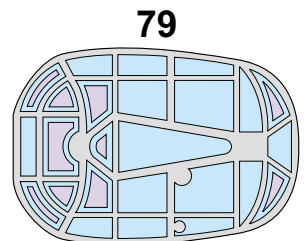

79

REFERENCES: Squadron/Signal Publ.: In Detail #64 - B-24 Liberator
Squadron/Signal Publ.: In Action #80 - B-24 Liberator
Aeroteam #8/1993 - B-24 Liberator
Revi #2/1994