



# Tornado ASSTA 3.1 interior

eduard

49 1137

1/48

detail set for 1/48 REVELL kit • sada detailů pro stavebnici 1/48 REVELL

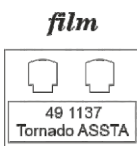
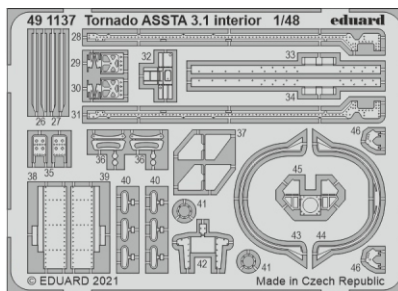
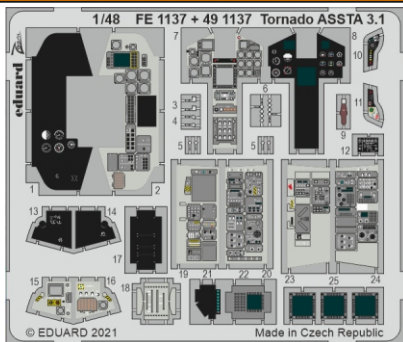

- APPLY EXPRESS MASK AND PAINT BEFORE GLUING  
POUŽIT EXPRESS MASK NABARVIT PŘED SLEPENÍM
- SYMMETRICAL ASSEMBLY  
SYMETRICKÁ MONTÁŽ
- REMOVE  
ODSTRANIT
- GRIND  
OBROUSIT
- DRILL HOLE  
VRTÁT OTVOR
- BEND  
OHNOUT
- OPTION  
VOLBA
- REPLACE  
NAHRADIT
- 1** COLORED ETCHED PARTS  
LEPTANÉ BAREVNÉ DÍLY
- 1** ETCHED PARTS  
LEPTANÉ NEBAREVNÉ DÍLY
- 1** ORIGINAL KIT PARTS  
PŮVODNÍ DÍLY STAVEBNICE

ORIGINAL KIT PARTS  
PŮVODNÍ DÍLY STAVEBNICE

PHOTO-ETCHED PARTS  
LEPTANÉ DÍLY

PARTS TO BE REMOVED  
DÍLY K ODSTRANĚNÍ

FILL  
TMELIT

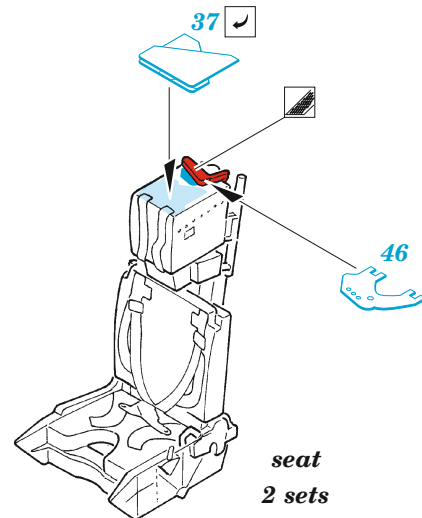
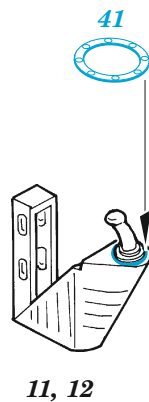
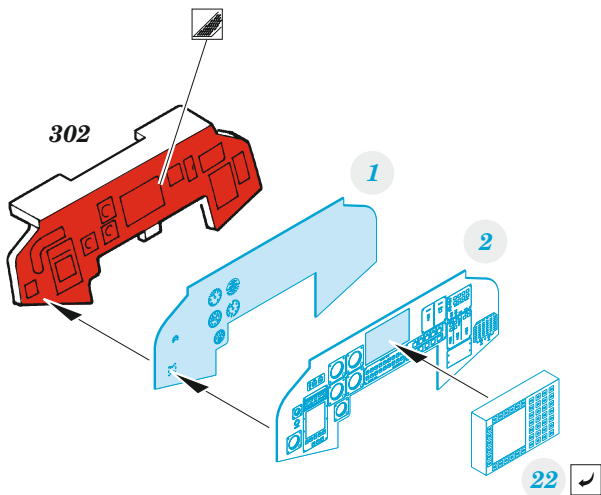
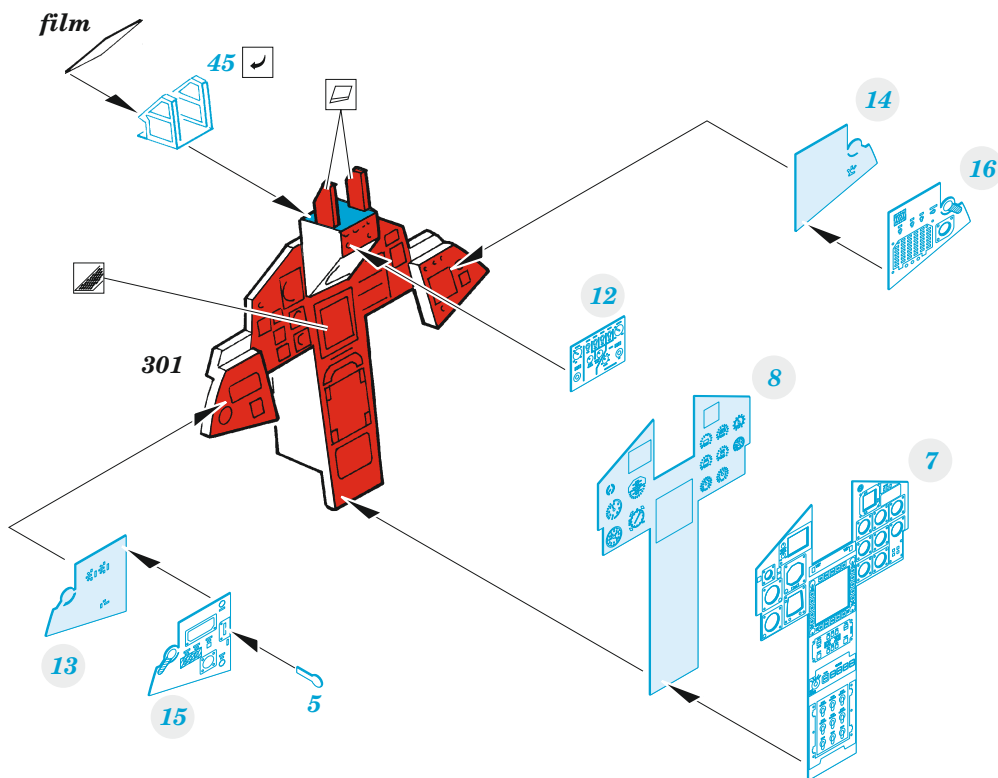

seat  
2 sets

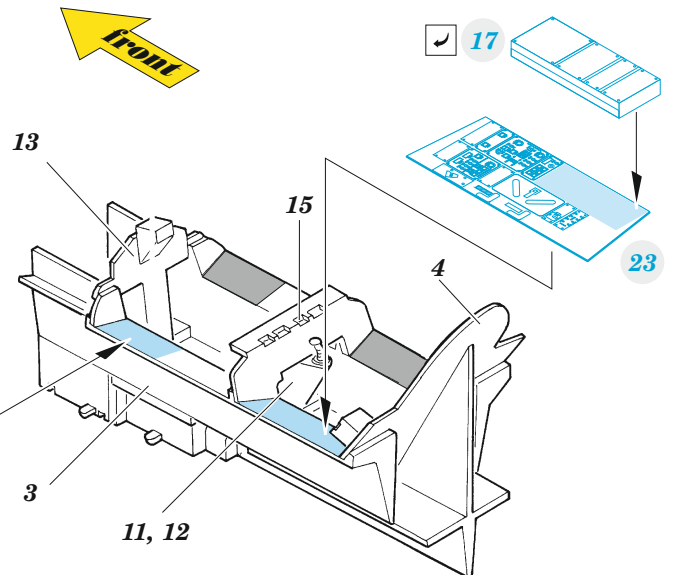
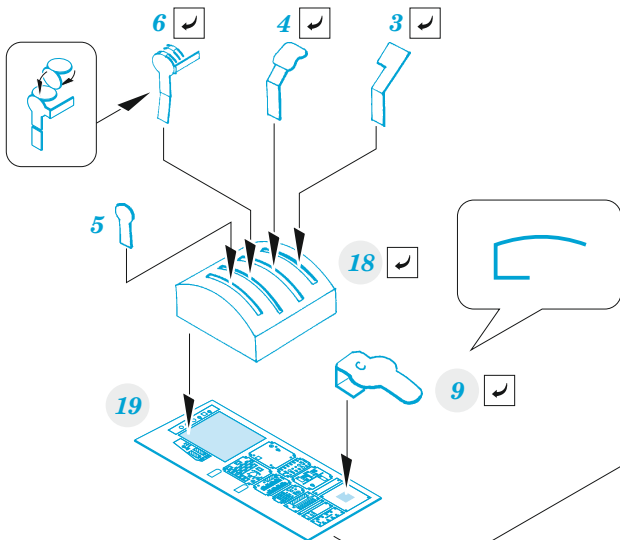
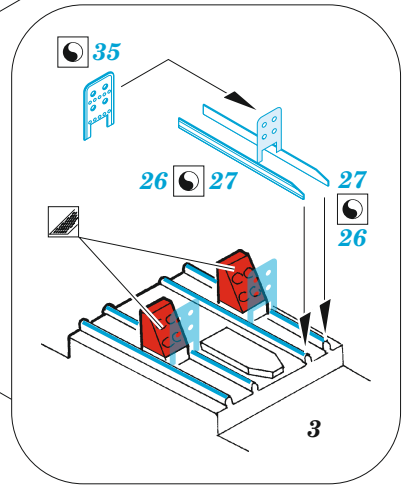
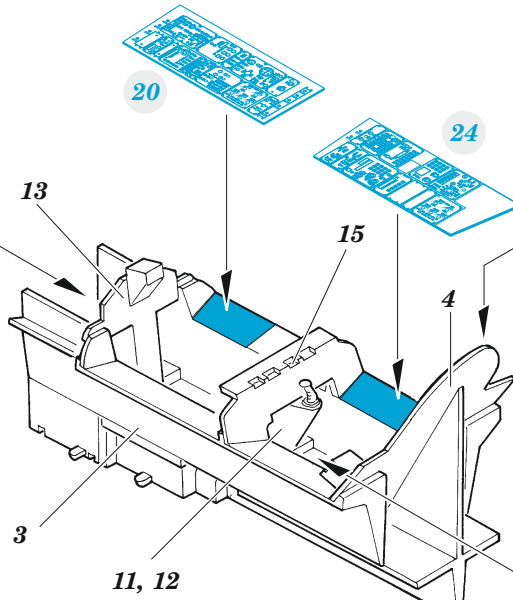
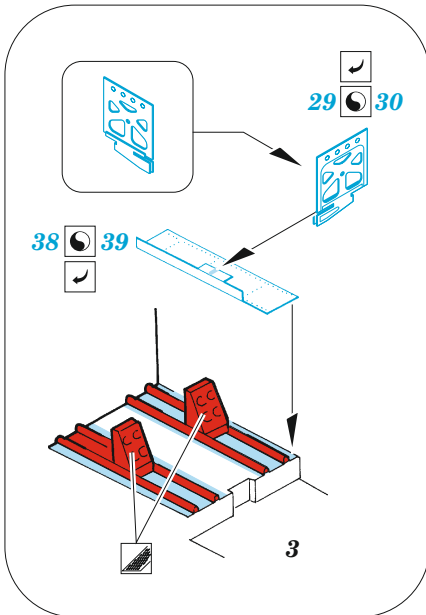
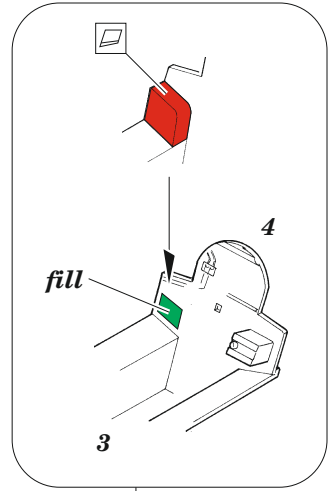
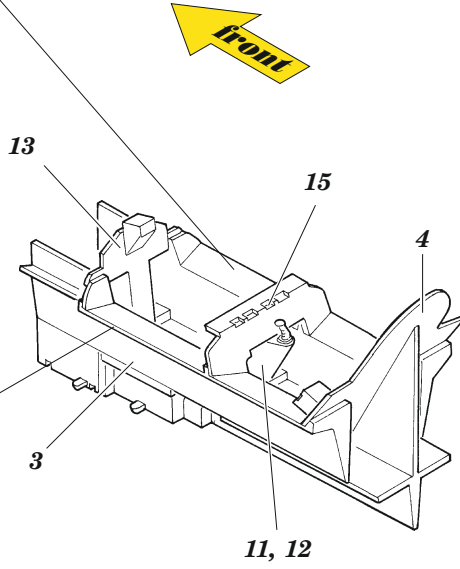
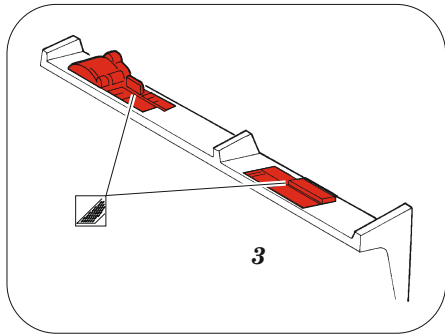
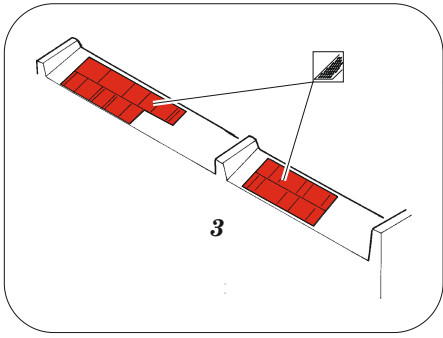

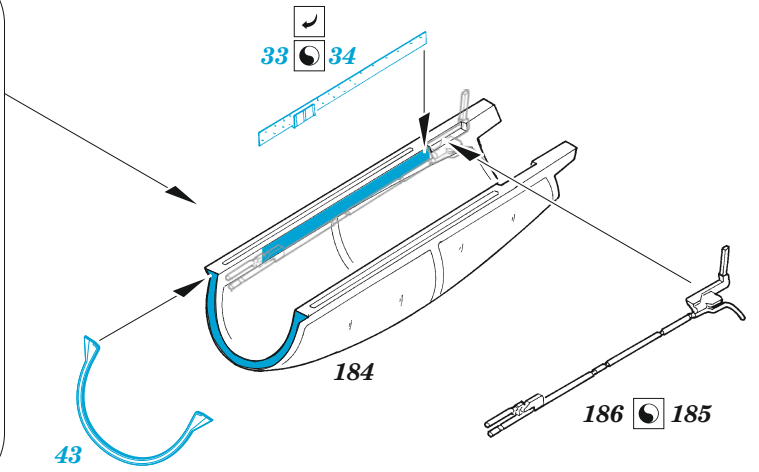
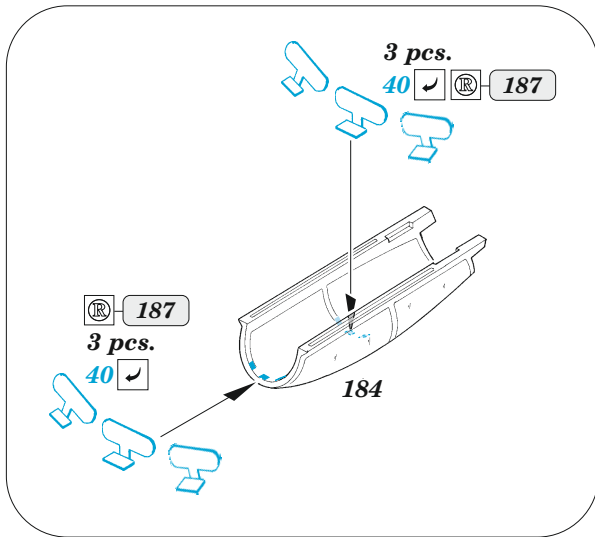
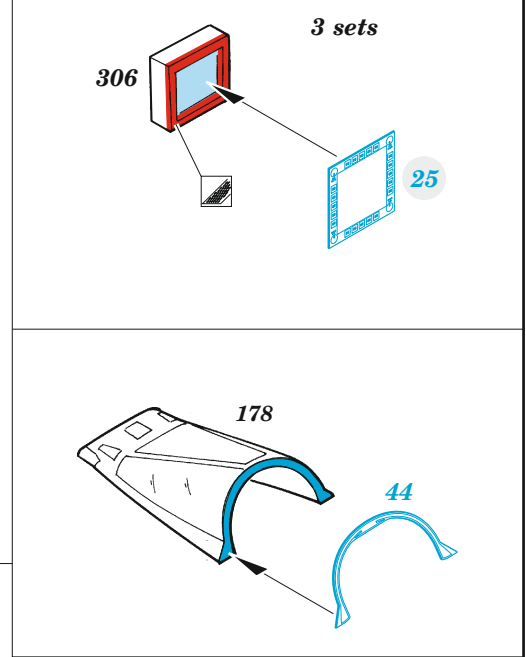
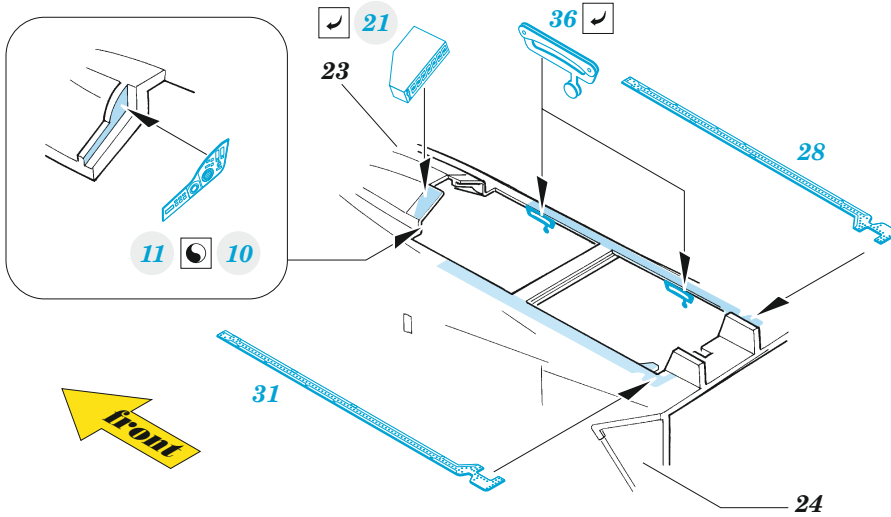

### Related products:

**FE 1138 Tornado ASSTA 3.1 seatbelts STEEL 1/48**

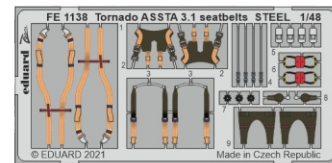

**49 1138 Tornado ASSTA 3.1 undercarriage 1/48**

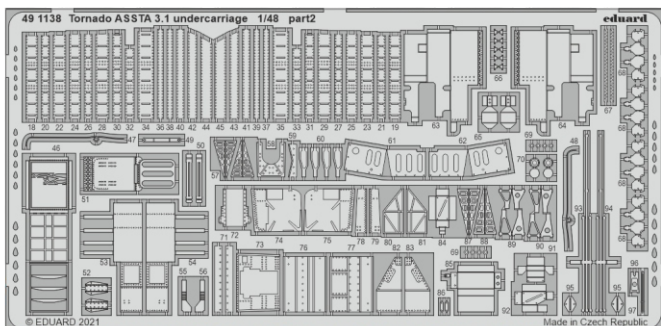
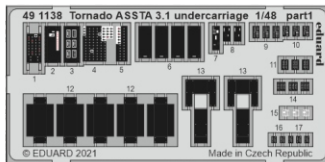

**48 1040 Tornado ASSTA 3.1 exterior 1/48**

